

GROUP
217 MONTGOMERY ST.
SYRACUSE, NEW YORK 13202
PHONE: 313-475-1273
FAX: 313-476-1283

TENANT IMPROVEMENT FOR:

2,289-SF TENANT SPACE
7035 MAILIUS CENTER ROAD
EAST SYRACUSE, NEW YORK 13057

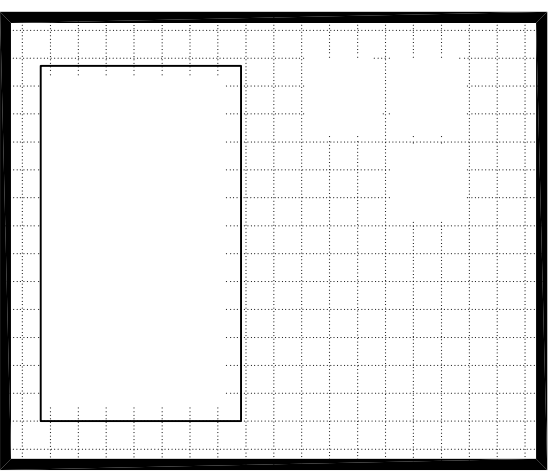

JOB NUM:	
DRAWN BY:	[FR]
CHECKED:	[PC]
DATE:	[04-03-17]
REVISIONS:	

DRAWING TITLE
FLOOR PLAN
SHEET NUMBER
A-1
A-1 FLOOR PLAN

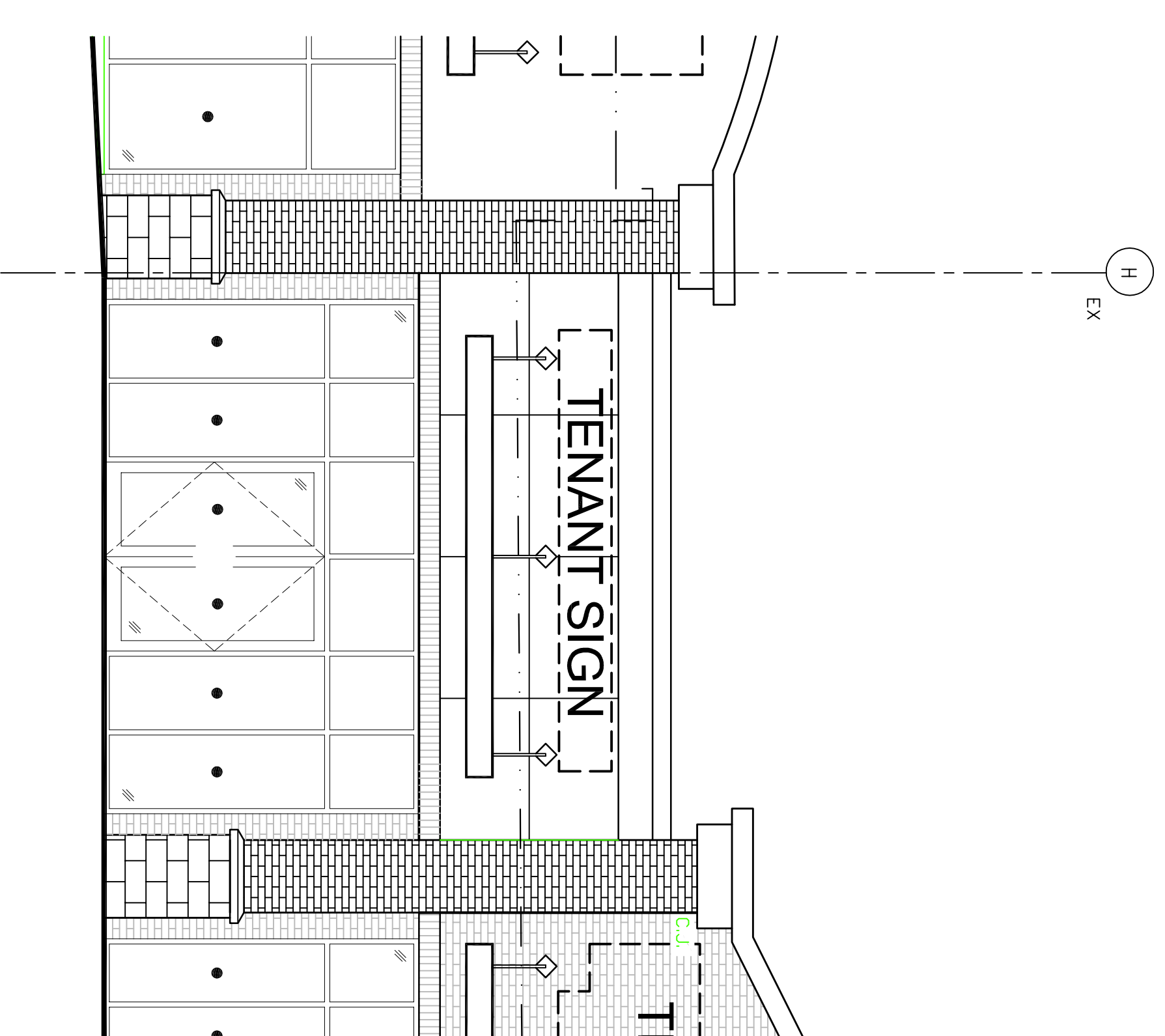

ELEVATION SCALE: 1/4" = 1'-0"

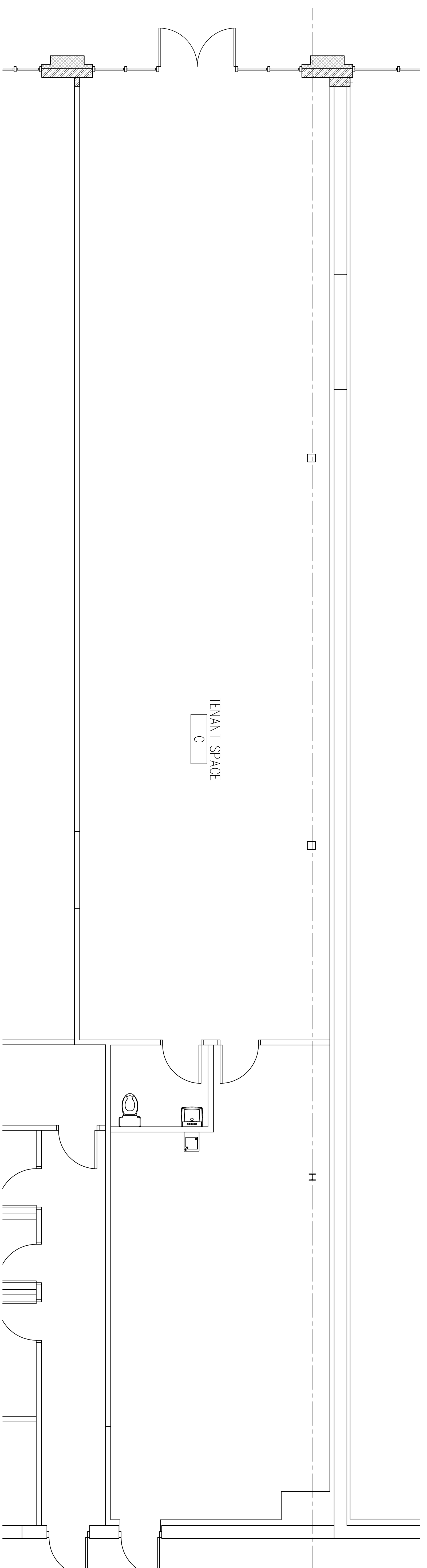

FLOOR PLAN SCALE: 1/4" = 1'-0"